

CONTOUR

Contour Camera Mobile App

Release Notes V1.3

March 22, 2011

These notes refer to the Contour mobile application and setup with the ContourGPS camera.

Bluetooth Setup

To use your camera with the Contour Camera mobile application, you will need to enable Bluetooth on it. *If you already updated your camera's firmware using Storyteller, you are ready to go.*

If you did not update the firmware to v 1.12 (or above) via Storyteller you will need to connect it to Storyteller (version 3.0.6) to obtain a valid Bluetooth ID.

To obtain a Bluetooth ID, simply connect your camera to your computer, launch Storyteller and wait a few minutes while we automatically look up the valid ID for your camera (you will need to be connected to the internet). To verify you have received a Bluetooth ID, browse to the root directory of the SD card on the camera and look for a file named 'bt.adr'. If the file is there, your camera has a valid Bluetooth ID and is ready to go.

If you cannot run Storyteller please contact Contour Support for assistance to obtain a Bluetooth ID.

See <http://contour.com/mobile> for detailed instructions on pairing your camera to your mobile device.

Pairing

1. Open the backdoor of the camera and remove the battery. Replace the card next to the battery with the Connect View card. Close the backdoor and power up the camera.

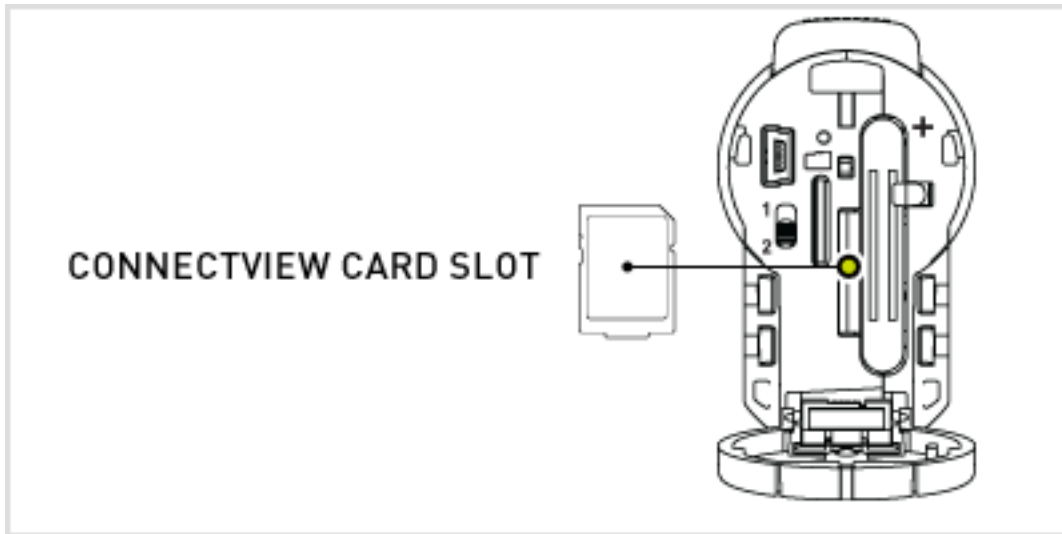

2. Locate the Bluetooth button in front of the record switch. Press and hold the button for five seconds before releasing. The front LED will begin flashing blue. (Note: if you slide the record switch forward the camera will go out of Bluetooth mode.)

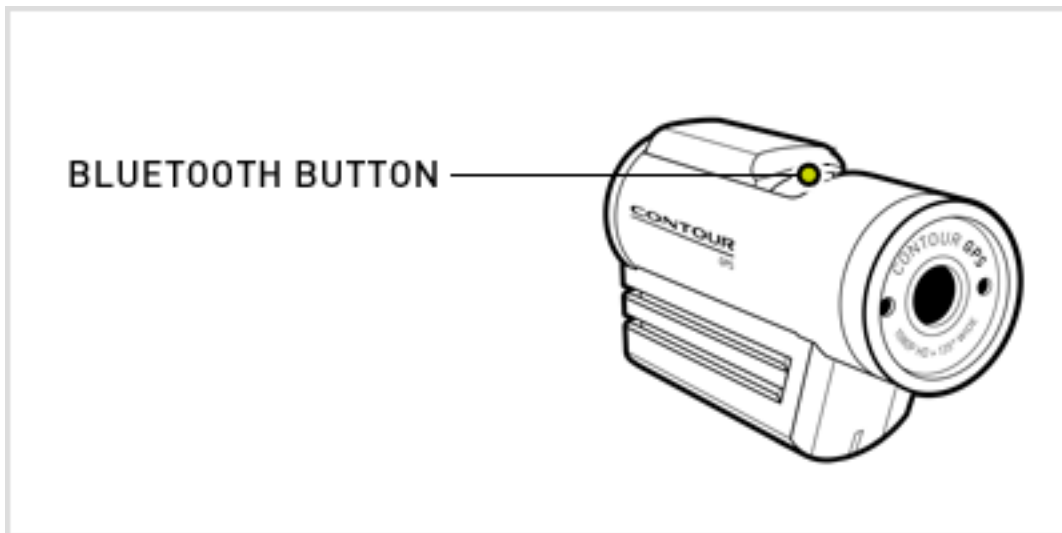

3. Go into your phone's settings and enable Bluetooth. Wait while your iOS locates the ContourGPS camera. Once you see 'ContourGPS', select it to tell your iOS to accept the pairing. You will know the pairing is complete when the front LED on the camera goes solid blue.
If a pairing cannot be established, push and release the Bluetooth button on the camera. Then repeat the process of pressing and holding the camera's Bluetooth button for five seconds. The ContourGPS camera should appear.
4. Open the Contour App and you should see what your camera sees! If your Bluetooth connection is lost the app will let you know; if this happens, you'll need to turn your Bluetooth back on by

pressing the Bluetooth button once. A single beep will sound and the camera will connect with the pre-existing pairing.

Troubleshooting & Known issues

- If the pairing connection between your ContourGPS camera and iOS devices is lost, the camera will make a double beep. At this point the Contour GPS app on your iOS device will start to search again for the Contour GPS camera. Press and release the Bluetooth button on your ContourGPS camera to make the camera available for the pairing connection. The ContourGPS camera will beep, the front status light will flash blue and then go solid blue once the Bluetooth connection has been reestablished.

- If the pairing connection between your ContourGPS camera and iOS devices is lost and the camera makes a triple beep, try the following steps:
 - Power the camera off and on.
 - Attempt the Bluetooth connection again. Press and release the Bluetooth button on your ContourGPS camera to make the camera available for the pairing connection. The ContourGPS camera will beep, the front status light will flash blue and then go solid blue once the Bluetooth connection has been reestablished.
 - If this does not work go to Settings/General/Bluetooth on your iOS device. Under 'Devices', select the option to forget the 'ContourGPS' device. Then establish a new pairing with your ContourGPS camera by following the instructions that came with your Connect View card.

- If the Contour GPS app live view freezes, and the buttons on the Contour GPS camera become unresponsive, the camera should automatically restart itself within 15 seconds. If it does not, try the following steps:
 - Remove and reinsert the ContourGPS camera's battery.
 - Power the camera on.
 - Attempt the Bluetooth connection again. Press and release the Bluetooth button on your ContourGPS camera to make the camera available for the pairing connection. The ContourGPS camera will beep, the front status light will flash blue and then go solid blue once the Bluetooth connection has been reestablished.

- If you cannot maintain a good connection between your iOS device and the ContourGPS camera, try the following:
 - Power your iOS device off and on.

- Press and release the Bluetooth button on your ContourGPS camera to make the camera available for the pairing connection. The ContourGPS camera will beep, the front status light will flash blue and then go solid blue once the Bluetooth connection has been reestablished.

Where can I get support?

Our support team is ready to help you. The contact information is:

- Hours: Monday: Friday 8am to 5pm PST
- USA toll free phone: (866) 397-6920
- International phone: +1 (206) 793-5226
- Web: <http://www.contour.com/support>